

### AquaBlade®

The cleaned surfaces are immediately dry. The rate of wear of AquaBlade® is marginal. AquaBlade® is immune to temperature change: The elasticity of the wiper blade is the same during winter and summer. The pulling of humidity does not require pressure which is needed for rubber squeegees. Therefore even tall and big surfaces can be cleaned and made streak-free as fast as small surfaces. The surfaces can even be shaped or rounded in any way; none of these surfaces alters the outcome of AquaBlade®.

#### Application area:

Cars (outside and inside), boats, buses, shower cubicles, photovoltaic roofs, windows (small and big), lacquer surfaces, floor tiles, glass-topped tables, glass doors, surfaces of plastic, laminate, parquet floor, Plexiglass, mirrors, winter gardens, caravans, trucks, yachts).

#### The use of AquaBlade®:

The wiper blade disposes a high rate of elasticity and adapts to the surface to absorb the water. It is necessary to put the whole wiper blade on the surface with little pressure. AquaBlade® absorbs the water from every angle; however, the water on the wiper blade needs to be taken off. You can also use AquaBlade® in a different way; you can make use of the water conveyance channel.

The use of AquaBlade® with the **water conveyance** channel

In order to use the water conveyance channel properly, the following instructions must be followed:

You can only use the wiper blade from top to bottom

You need to pull down slowly along the surface so that the water can flow into the water channel.

You also need to make use of a certain pressure on the wiper blade (on the bottom side) in order for the silicone blade to create a gap of approximately 1 – 2 mm. Thus the water on the wiper blade does not need to be cleared that often.

In order to empty the water conveyance channel the AquaBlade® must be held upright.

The use of AquaBlade® with the **telescopic arm**, which can be screwed in the handhold of AquaBlade®, is possible to use with or without water conveyance channel. After using AquaBlade® it will have to be cleaned properly and put down in order to dry.

#### Material of AquaBlade®:

Wiper blade: silicone/handhold adapter, Framing: plastic

#### Possible mistakes in use:

1. The streak-free drying will not be possible if only a part of the wiper blade is put on the surface.
2. The outcome will be damaged if the wiper blade is put on the surface with too much pressure. Be aware that you do not need as much pressure as other window drying products require. You only need to lay it on so that the silicone blade can adapt to the surface.
3. The surface is not streak-free after using AquaBlade®? The silicone blade does not cause streaks. Glass, for instance, in windows is a material with a porous structure (tiny gaps) where residues created by the cleaning agent might rest. These residues can cause streaks. In order to avoid streaks simply clean the surface properly with hot water and dishwashing liquid.

AquaBLADE®

## QUICK, EASY STREAK-FREE WINDOW CLEANING



**AquaBlade® Made in Italy**  
*Silicone Wiper Blade*  
*with a Water Conveyance System*  
**European Patent**

#### Contact us

Arkay Sales UK, Glenwood Business  
Park, Unit F8 Glenwood Place,  
Glasgow G45 9UH  
Tel: 0141 611 9705  
Email: [arkaysalesuk@gmail.com](mailto:arkaysalesuk@gmail.com)  
web : [www.arkayuk.co.uk](http://www.arkayuk.co.uk)

# ILLUSTRATION



## AquaBLADE

### Set content:

1. Aquablade Silikon 20 cm
2. Window Washer
3. Aquablade Silikon 30 cm
4. 30 cm microfiber cloth
5. handle 30 cm
6. 3pcs handle L.120cm

# HOW TO?

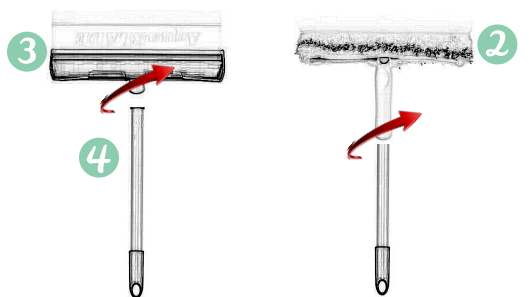

- Attach the Aquablade Silikon Wiper ① or ③ to the short handle ④.
- Attach the Window Washer ② to the short handle ④.

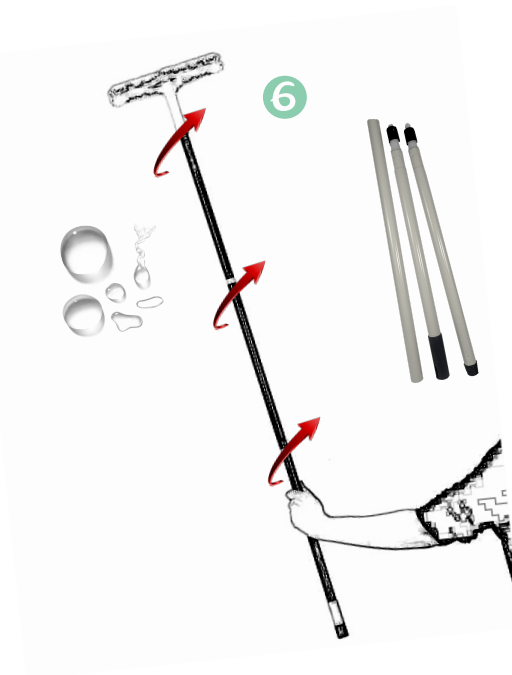

- Assemble the 3 pieces handle ⑥
- Attach the Window Washer ② to the extended handle ⑥.
- Attach the Aquablade Silikon Wiper ① or ③ to the extended handle ⑥.

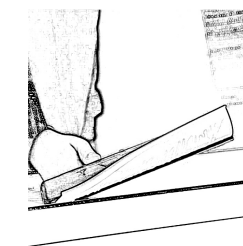

# EASY CLEANING

- For a cleaner finish, first wet the Window Washer ② and apply a couple of drops of your dishwashing liquid. Clean the surface to loosen the dirt.
- Then wipe the water off the window, working from top to bottom.
- Pull down slowly along the surface so that the water can flow into the water channel. Use of a certain pressure on the wiper blade (on the bottom side) in order for the silicone blade to create a gap of approximately 1 – 2 mm. Thus the water on the wiper blade does not need to be cleared that often. In order to empty the water conveyance channel the AquaBLADE® must to be held upright.